

# Advanced Control for IP Routing

NEW

With TSL Products' advanced broadcast control range, operators can now monitor and manage edge devices routed within an IP network via a unified control layer.

Removing the complexities operators may face when working with new IP systems, TSL's control solutions provides a simple and intuitive interface that translates new workflows to retain the familiarity of SDI routing.

Increasingly complex broadcast workflows drive the requirement for detailed yet simplified real-time signal flow management. By providing a universal tool that talks to a wide range of different manufactures and devices TSL's control platform creates a single point of entry for signal flow and routing control that streamlines workflows and brings about substantial operational cost savings.

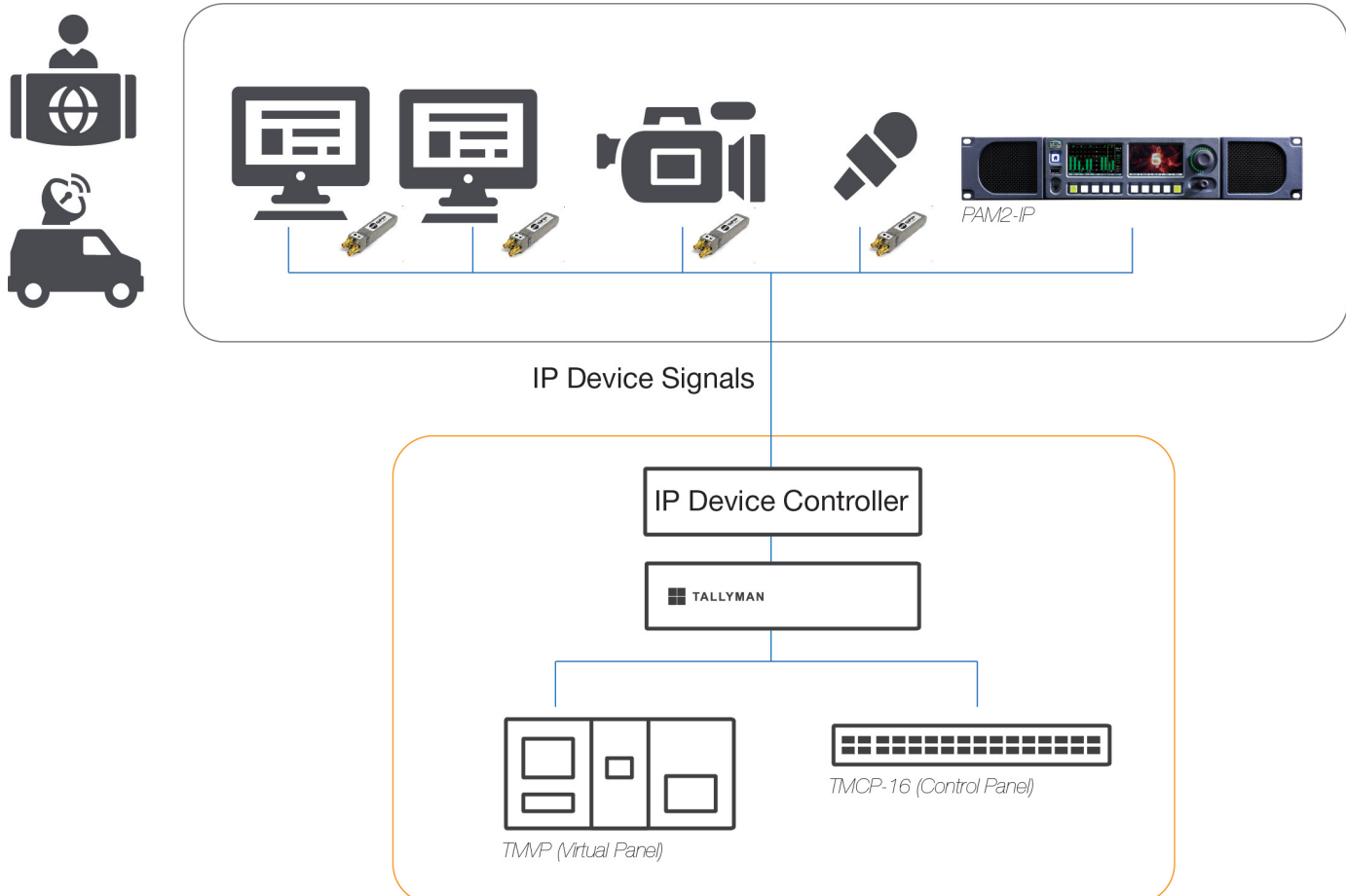

[www.tslproducts.com](http://www.tslproducts.com)

Contact our International Sales Team for more information:

E. [enquiries@tslproducts.com](mailto:enquiries@tslproducts.com) | T. +44 (0)1628 564 610



# Expanded Control Capabilities

TSL Products offer a control solution that integrates products to expand operations and enhance an operator's ability to simplify complex broadcast workflow, in particular for simple, stand-alone applications from production and master control to transmission of playout.

TSL's Advanced Broadcast Control System allows broadcasters to achieve interoperability between equipment regardless of manufacturers or format specifications, and can easily group multi-level actions into a simple control surface, providing a single, shared entry point for signal flow and routing control. Additional hardware acts as peripherals to TSL's existing control system, complimenting its capabilities with new expansion boxes and control panel options.

**AnyWhere Interface Boxes (AIB)** - equipped with fast ethernet and 8 to 16 GPI/O inputs/outputs for managing control application for projects of any size and remoting control. The Universal Switch Panels (USP) make it easy to create just the right control interface and give users control over only those functions needed to simplify operations and reduce errors.

**Control Processor** - offering simple, cost-effective and easily accessible solutions to time-triggered or time-delayed events, shared control between control positions and control facilities, and more. The SCTE 104 and 35 Control Drivers works with automation as well as standalone, controlling injectors/inserters and encoders. For affordable newscast automation, the Rundown Playout System Driver provides users with four server channels and a router or production switcher.

**IP Control Buddy** - providing a one-button solution for controlling equipment with PoE capabilities, including optional external power supply and the ability to mount in a 1-RU panel, desktop or control surface available with 1,2 or 4 buttons.

EB-44	EB-42	EB-41	EG-4
4- LCD Buttons 2	- LCD Buttons	1- LCD Buttons -	---
4- GPI Inputs	4- GPI Inputs	4- GPI Inputs	4- GPI Inputs
4- GPI Outputs 4	- GPI Outputs	4- GPI Outputs 4	- GPI Outputs
1- Serial Port RS422/RS232	1- Serial Port RS422/RS232	1- Serial Port RS422/RS232	1- Serial Port RS422/RS232
1- Ethernet 100BaseT Full Duplex	1- Ethernet 100BaseT Full Duplex	1- Ethernet 100BaseT Full Duplex	1- Ethernet 100BaseT Full Duplex
Power Over Ethernet	Power Over Ethernet	Power Over Ethernet	Power Over Ethernet
Horizontal & Vertical LCD Orientation	Horizontal & Vertical LCD Orientation	Horizontal & Vertical LCD Orientation	
4.75" W x 1.5" H x 2" D	4.75" W x 1.5" H x 2" D	4.75" W x 1.5" H x 2" D	4.75" W x 1.5" H x 2" D

[www.tslproducts.com](http://www.tslproducts.com)

Contact our International Sales Team for more information:

E. [enquiries@tslproducts.com](mailto:enquiries@tslproducts.com) | T. +44 (0)1628 564 610

